

# 一宮町東浪見土地区画整理事業 画地確定図

長生郡一宮町東野

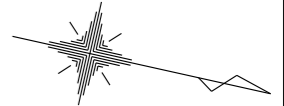

19-42	0.692	13.654	19-50	4.587	0.385	19-48
19-22	1.485	18.228	26.97m <sup>2</sup>	1.475	19-31	
19-23	0.824	18.228	15.08m <sup>2</sup>	0.830	19-30	
19-24	2.557	18.228	46.70m <sup>2</sup>	2.567	19-29	
19-25		18.223			19-28	

拡大図 1:250

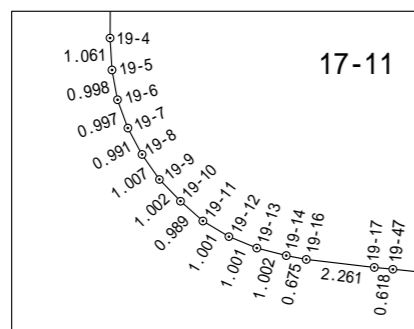

拡大図 1:250

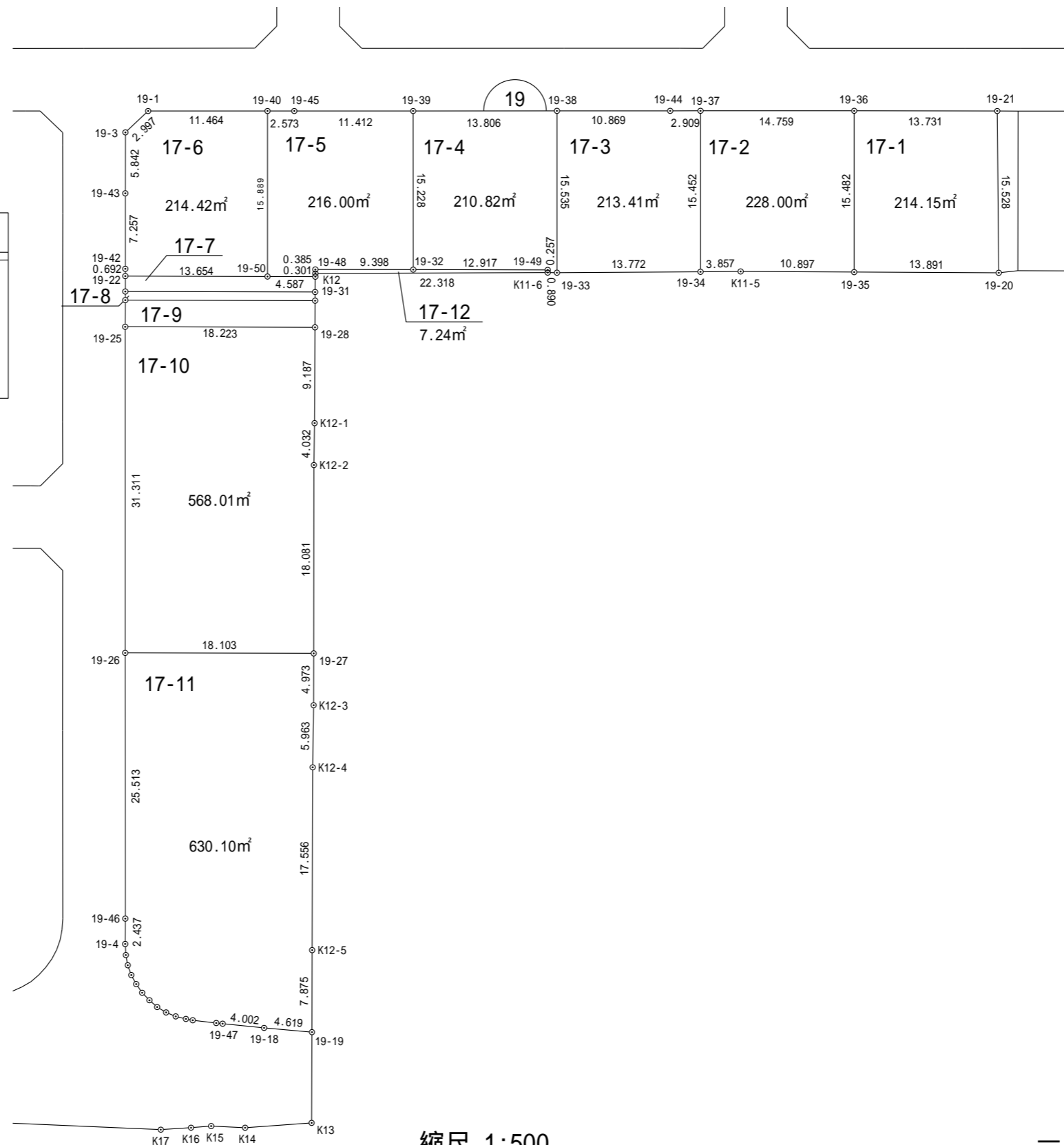

縮尺 1:500

## 座標法面積計算書

地番名	17-1					
点名	X	Y	距離	方向角	$X_{n+1} - X_{n-1}$	$Y_n \cdot (X_{n+1} - X_{n-1})$
19-36	-69956.114	48486.057	15.482	77° 28' 38"	-10.051	-487333.358907
19-35	-69952.757	48501.171	13.891	347° 43' 07"	16.931	821173.326201
19-20	-69939.183	48498.216	15.528	256° 53' 14"	10.051	487455.569016
19-21	-69942.706	48483.092	13.731	167° 31' 50"	-16.931	-820867.230652
					倍 面積	428.305658
					面積	214.15 m <sup>2</sup>

## 座標法面積計算書

地番名	17-2					
点名	X	Y	距離	方向角	$X_{n+1} - X_{n-1}$	$Y_n \cdot (X_{n+1} - X_{n-1})$
19-37	-69970.521	48489.264	15.452	77° 27' 37"	-11.052	-535903.345728
19-34	-69967.166	48504.348	3.857	347° 03' 32"	7.115	345108.436020
K11-5	-69963.406	48503.484	10.897	347° 44' 44"	14.409	698886.700956
19-35	-69952.757	48501.171	15.482	257° 28' 38"	7.292	353670.538932
19-36	-69956.114	48486.057	14.759	167° 27' 02"	-17.764	-861306.316548
					倍 面積	456.013632
					面積	228.00 m <sup>2</sup>

## 座標法面積計算書

地番名	17-3					
点名	X	Y	距離	方向角	$X_{n+1} - X_{n-1}$	$Y_n \cdot (X_{n+1} - X_{n-1})$
19-38	-69983.970	48492.262	15.535	77° 26' 01"	-7.230	-350599.054260
19-33	-69980.590	48507.425	13.772	347° 05' 24"	16.804	815118.769700
19-34	-69967.166	48504.348	15.452	257° 27' 37"	10.069	488390.280012
19-37	-69970.521	48489.264	2.909	167° 22' 23"	-6.194	-300342.501216
19-44	-69973.360	48489.900	10.869	167° 26' 58"	-13.449	-652140.665100
					倍 面積	426.829136
					面積	213.41 m <sup>2</sup>

## 座標法面積計算書

地番名	17-4					
点名	X	Y	距離	方向角	$X_{n+1} - X_{n-1}$	$Y_n \cdot (X_{n+1} - X_{n-1})$
19-39	-69997.443	48495.279	15.228	77° 26' 06"	-10.160	-492712.034640
19-32	-69994.130	48510.143	12.917	347° 34' 51"	15.928	772669.557704
19-49	-69981.515	48507.365	0.257	77° 41' 17"	12.670	614588.314550
K11-6	-69981.460	48507.617	0.890	347° 33' 18"	0.925	44869.545725
19-33	-69980.590	48507.425	15.535	257° 26' 01"	-2.510	-121753.636750
19-38	-69983.970	48492.262	13.806	167° 22' 41"	-16.853	-817240.091486
					倍 面 積	421.655103
					面 積	210.82 m <sup>2</sup>

## 座標法面積計算書

地番名	17-5					
点名	X	Y	距離	方向角	$X_{n+1} - X_{n-1}$	$Y_n \cdot (X_{n+1} - X_{n-1})$
19-40	-70011.094	48498.322	15.889	77° 26' 56"	0.941	45636.921002
19-50	-70007.641	48513.832	4.587	347° 34' 32"	7.933	384860.229256
19-31	-70003.161	48512.845	0.301	257° 31' 59"	4.415	214184.210675
K12	-70003.226	48512.551	0.385	258° 01' 10"	-0.145	-7034.319895
19-48	-70003.306	48512.174	9.398	347° 31' 10"	9.096	441266.734704
19-32	-69994.130	48510.143	15.228	257° 26' 06"	5.863	284414.968409
19-39	-69997.443	48495.279	11.412	167° 25' 43"	-14.452	-700853.772108
19-45	-70008.582	48497.763	2.573	167° 27' 15"	-13.651	-662042.962713
倍面積						432.009330
面積						216.00 m <sup>2</sup>

## 座標法面積計算書

地番名	17-6					
点名	X	Y	距離	方向角	$X_{n+1} - X_{n-1}$	$Y_n \cdot (X_{n+1} - X_{n-1})$
19-1	-70022.285	48500.812	2.997	124° 08' 07"	-12.873	-624350.952876
19-3	-70023.967	48503.293	5.842	77° 33' 19"	-0.423	-20516.892939
19-43	-70022.708	48508.998	7.257	77° 26' 31"	2.837	137620.027326
19-42	-70021.130	48516.082	0.692	77° 19' 40"	1.730	83932.821860
19-22	-70020.978	48516.758	13.654	347° 37' 33"	13.489	654442.548662
19-50	-70007.641	48513.832	15.889	257° 26' 56"	9.884	479510.715488
19-40	-70011.094	48498.322	11.464	167° 27' 22"	-14.644	-710209.427368
					倍 面 積	428.840153
					面 積	214.42 m <sup>2</sup>

## 座標法面積計算書

地番名	17-7					
点名	X	Y	距離	方向角	$X_{n+1} - X_{n-1}$	$Y_n \cdot (X_{n+1} - X_{n-1})$
19-22	-70020.978	48516.758	1.485	77° 33' 48"	-13.017	-631542.638886
19-23	-70020.658	48518.209	18.228	347° 34' 54"	18.122	879246.983498
19-30	-70002.856	48514.289	1.475	258° 04' 24"	17.497	848854.514633
19-31	-70003.161	48512.845	4.587	167° 34' 32"	-4.785	-232133.963325
19-50	-70007.641	48513.832	13.654	167° 37' 33"	-17.817	-864370.944744
					倍 面積	53.951176
					面積	26.97 m <sup>2</sup>



## 座標法面積計算書

地番名	17-8					
点名	X	Y	距離	方向角	$X_{n+1} - X_{n-1}$	$Y_n \cdot (X_{n+1} - X_{n-1})$
19-23	-70020.658	48518.209	0.824	77° 27' 49"	-17.623	-855036.397207
19-24	-70020.479	48519.014	18.228	347° 36' 03"	17.982	872468.909748
19-29	-70002.676	48515.100	0.830	257° 29' 10"	17.623	854981.607300
19-30	-70002.856	48514.289	18.228	167° 34' 54"	-17.982	-872383.944798
倍 面 積						30.175043
面 積						15.08 m <sup>2</sup>

## 座標法面積計算書

地番名	17-9					
点名	X	Y	距離	方向角	$X_{n+1} - X_{n-1}$	$Y_n \cdot (X_{n+1} - X_{n-1})$
19-24	-70020.479	48519.014	2.557	77° 30' 45"	-17.250	-836952.991500
19-25	-70019.926	48521.511	18.223	347° 37' 59"	18.354	890563.812894
19-28	-70002.125	48517.608	2.567	257° 36' 33"	17.250	836928.738000
19-29	-70002.676	48515.100	18.228	167° 36' 03"	-18.354	-890446.145400
					倍 面積	93.413994
					面積	46.70 m <sup>2</sup>

## 座標法面積計算書

地番名	17-10					
点名	X	Y	距離	方向角	$X_{n+1} - X_{n-1}$	$Y_n \cdot (X_{n+1} - X_{n-1})$
19-25	-70019.926	48521.511	31.311	77° 27' 12"	-10.999	-533688.099489
19-26	-70013.124	48552.075	18.103	347° 35' 54"	24.483	1188700.452225
19-27	-69995.443	48548.187	18.081	257° 30' 06"	13.768	668411.438616
K12-2	-69999.356	48530.534	4.032	258° 24' 41"	-4.723	-229209.712082
K12-1	-70000.166	48526.584	9.187	257° 41' 18"	-2.769	-134370.111096
19-28	-70002.125	48517.608	18.223	167° 37' 59"	-19.760	-958707.934080
					倍面積	1136.034094
					面積	568.01 m <sup>2</sup>

## 座標法面積計算書

地番名	17-11					
点名	X	Y	距離	方向角	$X_{n+1} - X_{n-1}$	$Y_n \cdot (X_{n+1} - X_{n-1})$
19-26	-70013.124	48552.075	25.513	77° 25' 11"	-12.124	-588645.357300
19-46	-70007.567	48576.976	2.437	77° 42' 30"	6.076	295153.706176
19-4	-70007.048	48579.358	1.061	73° 55' 16"	0.813	39495.018054
19-5	-70006.754	48580.378	0.998	66° 57' 07"	0.685	33277.558930
19-6	-70006.363	48581.297	0.997	57° 26' 27"	0.928	45083.443616
19-7	-70005.826	48582.138	0.991	49° 10' 23"	1.185	57569.833530
19-8	-70005.178	48582.888	1.007	42° 42' 22"	1.388	67433.048544
19-9	-70004.438	48583.571	1.002	33° 21' 25"	1.577	76616.291467
19-10	-70003.601	48584.122	0.989	28° 53' 49"	1.703	82738.759766
19-11	-70002.735	48584.600	1.001	18° 23' 56"	1.816	88229.633600
19-12	-70001.785	48584.916	1.001	9° 46' 22"	1.937	94108.982292
19-13	-70000.798	48585.086	1.002	1° 42' 54"	1.989	96635.736054
19-14	-69999.796	48585.116	0.675	358° 08' 00"	1.677	81477.239532
19-16	-69999.121	48585.094	2.261	354° 09' 48"	2.925	142111.399950
19-17	-69996.871	48584.864	0.618	353° 18' 43"	2.864	139147.050496
19-47	-69996.257	48584.792	4.002	353° 15' 24"	4.589	222955.610488
19-18	-69992.282	48584.322	4.619	352° 32' 11"	8.555	415638.874710
19-19	-69987.702	48583.722	7.875	257° 33' 20"	2.883	140066.870526
K12-5	-69989.399	48576.032	17.556	257° 37' 48"	-5.458	-265127.982656
K12-4	-69993.160	48558.883	5.963	258° 16' 59"	-4.972	-241434.766276
K12-3	-69994.371	48553.044	4.973	257° 33' 13"	-2.283	-110846.599452
19-27	-69995.443	48548.187	18.103	167° 35' 54"	-18.753	-910424.150811
					倍 面積	1260.201236
					面積	630.10 m <sup>2</sup>

## 座標法面積計算書

地番名	17-12					
点名	X	Y	距離	方向角	$X_{n+1} - X_{n-1}$	$Y_n \cdot (X_{n+1} - X_{n-1})$
19-48	-70003.306	48512.174	0.385	78° 01' 10"	-9.096	-441266.734704
K12	-70003.226	48512.551	22.318	347° 13' 40"	21.846	1059805.189146
K11-6	-69981.460	48507.617	0.257	257° 41' 17"	21.711	1053148.872687
19-49	-69981.515	48507.365	12.917	167° 34' 51"	-12.670	-614588.314550
19-32	-69994.130	48510.143	9.398	167° 31' 10"	-21.791	-1057084.526113
					倍 面積	14.486466
					面積	7.24 m <sup>2</sup>